

OAKEN SQUARE LARGE AC SPEC SHEET



OAK-Q-L-AC



IP66
WATER
PROOF



20W / 15W

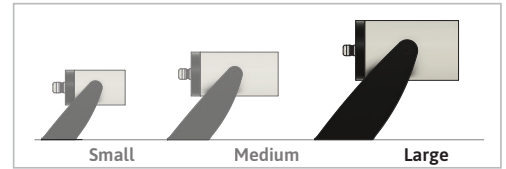

The Oaken series LED spotlights are a practical and aesthetic solution for highlighting outdoor areas. They are available with five optic configurations, ultra narrow, narrow, medium, wide and ultra wide for flexibility. With a chemically sealed glass lens and proprietary moisture barriers, the luminaire is capable of withstanding extreme outdoor conditions with consistent performance.

SPECIFICATION

| | 20W | 15W |
|-------------------------------------|--|--------|
| OPERATING VOLTAGE | 120 - 277 VAC | |
| OPERATING TEMPERATURE | -20°C to + 50°C | |
| CRI | 80, 90* (* = special order) | |
| CONTROL | 0-10 V Dimmable | |
| INPUT CURRENT @115 VAC, 60Hz | 173 mA | 128 mA |
| INPUT CURRENT @230 VAC, 50Hz | 87 mA | 67 mA |
| NO OF LED | 1 | |
| LIGHT SOURCE | Cree COB | |
| CCT | 2200K, 2700K, 3000K, 3500K, 4000K, 5000K | |
| BEAM ANGLE | 13°, 21°, 30°, 44°, 52° | |
| FIXTURE CONNECTION | Pigtail | |
| AVAILABLE IP RATING | IP66 | |

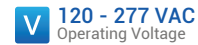

*" represent special order, please contact factory for detail.

OPTICAL DATA (3000K)

| Beam Angle | 20W | 15W |
|------------------|---------|---------|
| 13° Ultra Narrow | 1509 lm | 1132 lm |
| 21° Narrow | 1582 lm | 1187 lm |
| 30° Medium | 1462lm | 1097 lm |
| 44° Wide | 1445 lm | 1084 lm |
| 52° Ultra Wide | 1444 lm | 1083 lm |

DELIVERED LUMENS BY CCT (Narrow beam 21°)

| White | 20W | 15W |
|-------|---------|---------|
| 2200K | 1280 lm | 961 lm |
| 2700K | 1483 lm | 1113 lm |
| 3000K | 1582 lm | 1187 lm |
| 3500K | 1587 lm | 1191 lm |
| 4000K | 1554 lm | 1166 lm |
| 5000K | 1547 lm | 1161 lm |

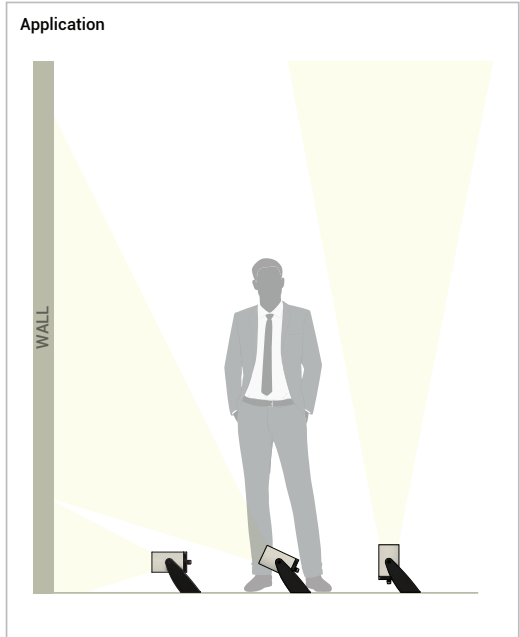

Spike Mount

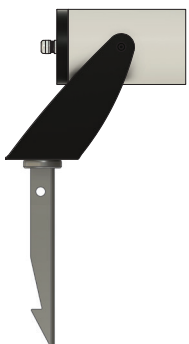

180° Angle Swivel Base

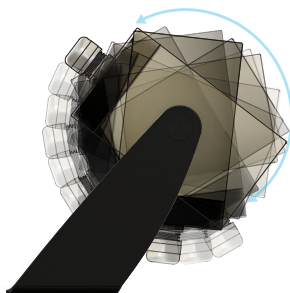

Honeycomb Louver (Optional)

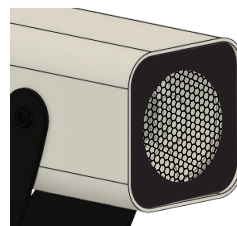

Visor (Optional)

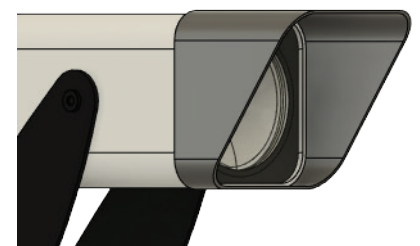

OAKEN SQUARE LARGE AC SPEC SHEET



OAK-Q-L-AC

ORDERING CODE

| PRODUCT SERIES | TYPE | SIZE | POWER | COLOR TEMPERATURE | CRI | BEAM ANGLE | CONTROL | MOUNTING | VOLTAGE | ACCESSORIES |
|----------------|------------|-----------|----------------------------------|--|----------------------|---|------------------------------|--|------------------|--|
| OAK - Oaken | Q - Square | L - Large | 15W - 15 Watts 20W - 20 Watts | CT22 - 2200K CT27 - 2700K CT30 - 3000K CT35 - 3500K CT40 - 4000K CT50 - 5000K | 80 - 90 90* - 90* | 13D - 13 Degree 21D - 21 Degree 30D - 30 Degree 44D - 44 Degree 52D - 52 Degree | SW - Switched TRI - TRIAC | SM - Surface Mount SP - Spike Mount | AC - 120-277 VAC | N - None H - Honeycomb V - Visor |

| FIXTURE FINISHING | |
|-------------------|--------------|
| BODY FINISH | TRIM FINISH |
| BWH - White | TWH - White |
| BBL - Black | TBL - Black |
| BSL - Silver | TSL - Silver |
| BXX - Custom | TGD - Gold |
| | TXX - Custom |

Sample: OAK-Q-L-20W-CT22-80-13D-SW-SM-AC-H-BWH-TBL

DIMENSIONS

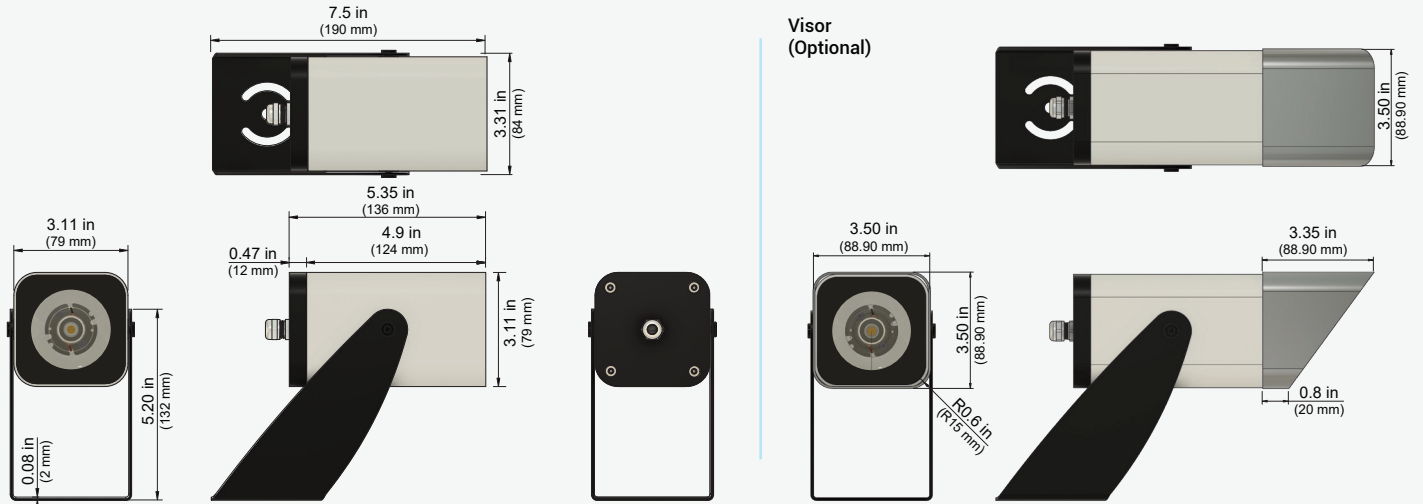

PHOTOMETRIC DATA

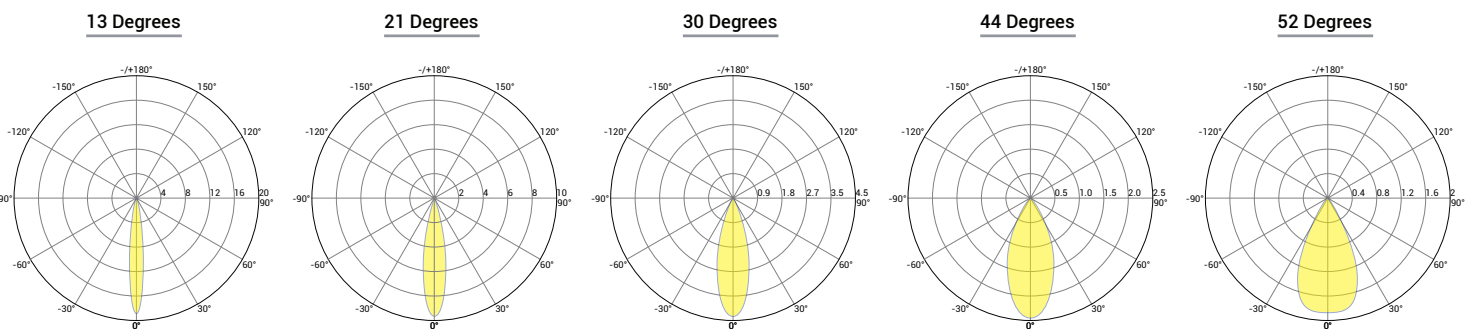

BIN Details (CIE 1931)

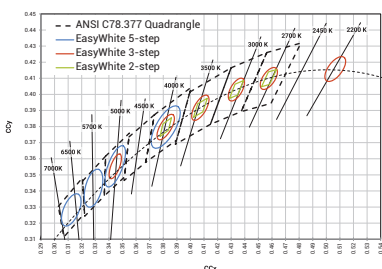

Spectral Distribution

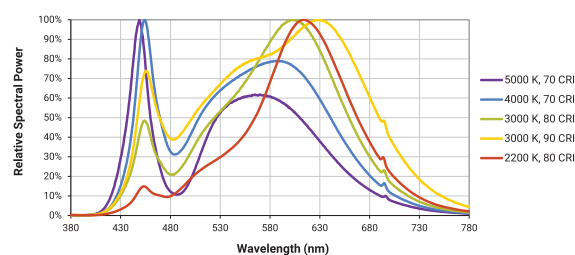

RELATED PRODUCTS

OAK - Square Large - DC

