

# VERTEX-AC SPEC SHEET



VTX-AC



**IP66**  
WATER  
PROOF



**CE** **RoHS**

YYZ Vertex series is a new surface mounted frameless slim shape weatherproof luminaire in soft and high LED or RGBW version specially designed for facade and in unique structure design shape. This series are designed to offer functional, a wide range of lighting solutions and dramatic highlighting of the architectural facades of different buildings, malls through the linear curved design with superior finishing as well highest efficiency with a long service life.

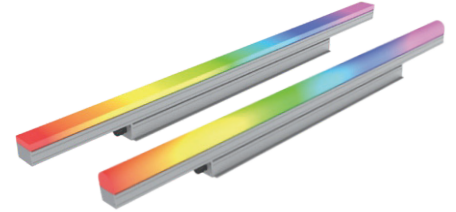

## FEATURES

FINISH	6063 High density extruded aluminum
WORKING VOLTAGE	120-277 V ac 50/60Hz
RATED POWER	3W/ft, 5W/ft, 7.5W/ft
BEAM ANGLE	110° x 130°(Flat diffuser), 110° x 170°(Round diffuser), 120°(Clear diffuser)
AVAILABLE LENGTH	300mm, 600mm, 900mm, 1200mm
MOUNTING	Surface mounting
OPTIC	Square Acrylic Diffuser, Round Acrylic Diffuser, Clear Diffuser
DIMENSIONS	300, 600, 900, 1200(L) x 40(W) x 72(H)
OPERATION TEMP	-10° C - +50° C
STORAGE TEMP	-30° C - +60° C
LAMP LIFE	50,000 hrs
BODY COLOR	Black, Grey, White
CONTROL	On/Off, DMX

**CREE / NICHIA / EPISTAR / OSRAM**  
LED Quality

**120-277 VAC**  
Working Voltage

**3W/ft, 5W/ft, 7.5W/ft**  
Rated power

## ELECTRICAL DATA

POWER CONSUMPTION	3W/ft, 5W/ft, 7.5W/ft
SUPPLY VOLTAGE	120-277 V AC 50/60Hz
COLORS	RGB, RGBW (W-1800K, 2700K, 3000K, 4000K, 6500K)
CRI	80
PIXEL DISTANCE	50mm - 6pixels per foot (8 pixels in 400mm) 100mm - 3 pixels per foot (4 pixels in 400mm)

## DIMENSION

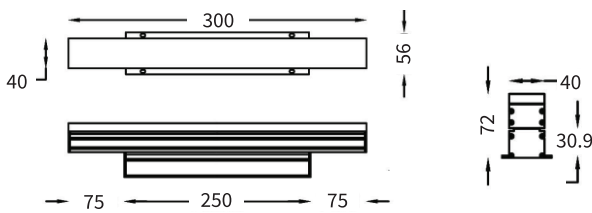

**VTX-AC FLAT DIFFUSER**

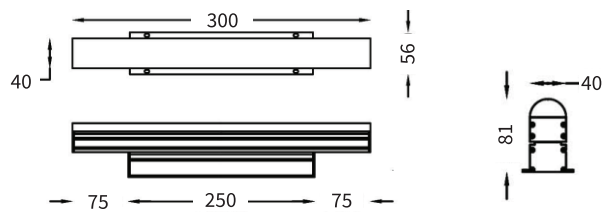

**VTX-AC ROUND DIFFUSER**

## ORDERING CODE

PRODUCT	POWER	OPTIC	COLOR TEMPERATURE	CONTROL	FIXTURE LENGTH	BODY COLOR	CUSTOM
VTX-AC F - Flat Diffuser	3 - 3W/ft	110x130 - 110° x 130°(Flat diffuser)	(RGB) RGB	SW - On/Off	30 - 300mm	BK - BLACK	XX
VTX-AC R - Round Diffuser	5 - 5W/ft	110x170 - 110° x 170°(Round diffuser)	(RGBW) RGBW	DMX - DMX	60 - 600mm	GR - GREY	
VTX-AC C - Clear Diffuser	7.5 - 7.5W/ft	120 - 120°(Clear diffuser)	(RGB18) RGB1800K (RGB27) RGB2700K (RGB30) RGB3000K (RGB40) RGB4000K (RGB65) RGB6500K		90 - 900mm 120 - 1200mm	WH - WHITE	

Sample: VTX-AC F - 3 - 110x130 - RGB - SW - 30 - BK - XX

### MOUNTING ACCESSORIES

ITEM: YYZMBA-H81

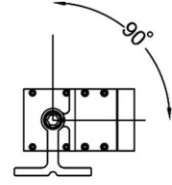
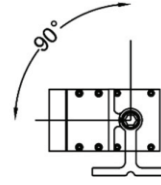
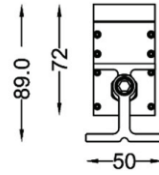
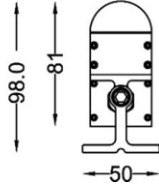
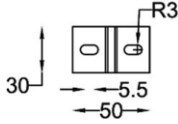

ITEM: YYZMBA-100

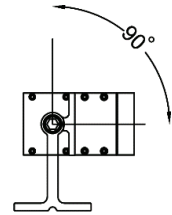
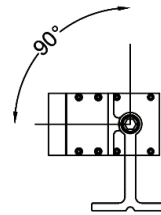
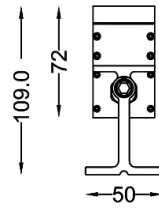
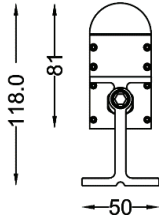
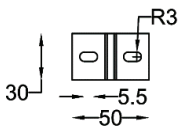

ITEM: YYZMBA-L101

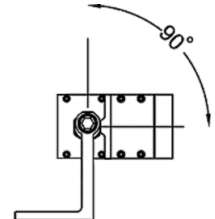
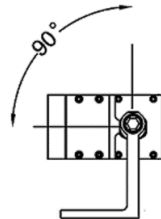
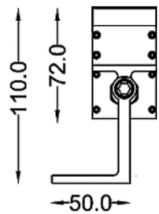
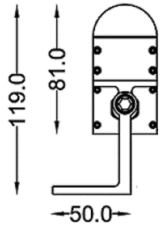
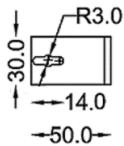

### CONNECTING ACCESSORIES

#### LEAD-IN AND JUMPER CABLE

Product Image	Part Number	Length (mm)	Application	Cable End		Conductor Size	Region
	YYZCF-300-6pin-EU	300	Power and Data Combined Lead	Female	Bare Wire	3 x 16AWG (1.5mm <sup>2</sup> ) + 3 x 22AWG (0.3mm <sup>2</sup> )	Europe
	YYZCF-300-6pin-US						USA
	YYZCF-2000-6pin-EU	2000					Europe
	YYZCF-2000-6pin-US						USA
	YYZCF-6000-6pin-EU	6000					Europe
	YYZCF-6000-6pin-US						USA
	YYZCF-15000-6pin-EU	15000					Europe
	YYZCF-15000-6pin-US						USA
	YYZCL-003-6pin-EU	300	Power and Data Combined extension	Female	Male	3 x 22AWG (0.3mm <sup>2</sup> )	Europe
	YYZCL-003-6pin-US						USA
	YYZCL-006-6pin-EU	600					Europe
	YYZCL-006-6pin-US						USA
	YYZCL-018-6pin-EU	1800					Europe
	YYZCL-018-6pin-US						USA

### T- JOINTS

Product Image	Part Number	Application	Description
	AC-P-INJECT-T636	Power Injector (DMX)	T connector 6-pin male to 6-pin female with AC power (3pin male power injector)
	AC-S-INJECT-T636	Signal Injector (DMX)	T connector 6-pin male to 6-pin female with DMX signal (3pin male signal injector)

### IP RATED END CAP

Part Number : DMX-Term-AC-6pin



### ADDRESS WRITER AND TESTER

ITEM : DMX cat



### WIRING DETAILS

The core in the power and data cable are colored according to the following table:

Cable	Function	Core(US)	Wire Size
Power lead in/ Power extension Cable	L (live)	Black	16AWG
	N (Neutral)	White	16AWG
	GND (Earth)	Green	16AWG
Data lead in	DMX+	Purple	22AWG
	DMX-	Gray	22AWG
	DMX GND	Yellow	22AWG
Power and Data lead in/ Power data extension cable	L (live)	Black	16AWG
	N (Neutral)	White	16AWG
	GND (Earth)	Green	16AWG
	DMX+	Purple	22AWG
	DMX-	Gray	22AWG
	DMX GND	Yellow	22AWG

The maximum number of connected fixtures in a daisy chain (Power):

Power/ft	Region	Main Voltage	Max. power	Max. no. of 4 ft fixtures can be clusted
7.8W	US	120V	1020W	32 nos.
7.8W	EU	220-240V	1870W	59 nos.

The maximum number of connected fixtures in a daisy chain (Signal):

Pixel/4fts	Pixel Distance	No. of Channels	Protocol	Max. no. of 4 ft fixtures can be clusted
1 pxiel	Per Fixture	4 Channels	DMX 512	32 nos.
12 pixels	100mm	48 Channels		10 nos.
24 pixels	50mm	96 Channels		5 nos.

Note: The above values and number are only typical values. Actual number may vary due to the cable lengths and signal source.