

LINEAR WALLWASHER INSTALLATION

RWW40

IP66
WATER
PROOF



INSTALLATION

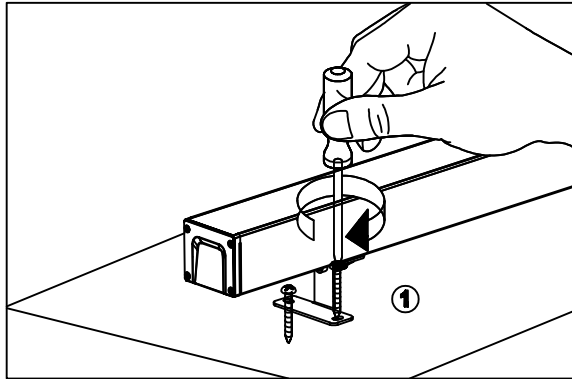

1. Fix the fixture with screws on the surface of the mounted object, make sure the fixing position.

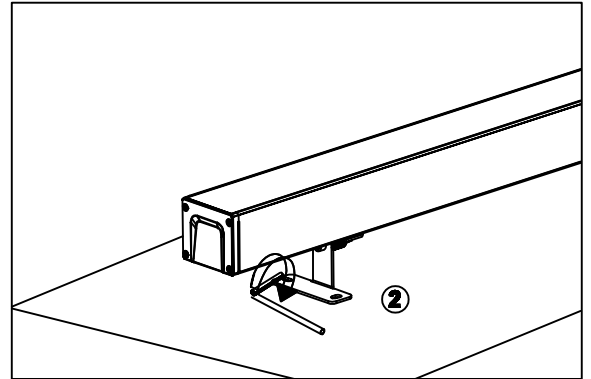

2. Rotate the fixture body to a suitable projection angle.

WIRING DIAGRAM

220VAC - Mono Color

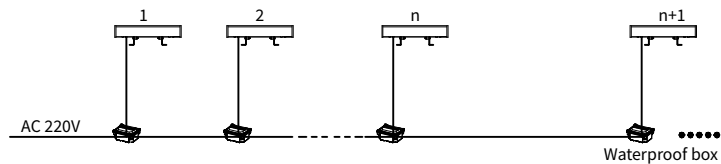
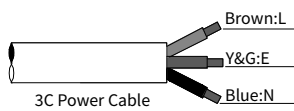

24VDC - Mono Color

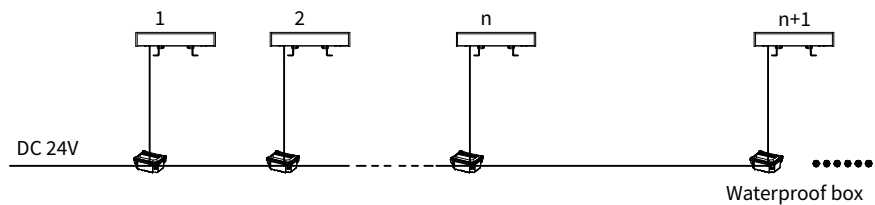
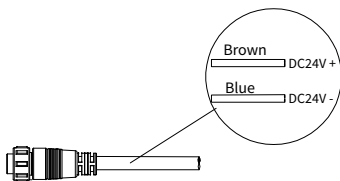

DMX512

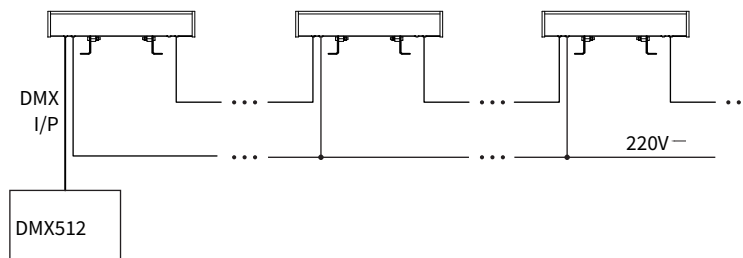

WARNING	CAUTION
<ul style="list-style-type: none"> ⚠ Disconnect or turn off power before installation, maintenance or service. ⚠ Allow lamp/fixture to cool before handling. ⚠ Do not touch enclosure or light source. ⚠ Verify that supply voltage is correct by comparing it with the luminaire label information. 	<ul style="list-style-type: none"> ⚠ Keep combustible and other materials that can burn, away from lamp/lens. ⚠ Do not operate in close proximity to persons, combustible materials or substances affected by heat or dying. ⚠ Wear gloves and safety glasses at all times when removing luminaire from carton, installing, servicing or performing maintenance. ⚠ Avoid direct eye exposure to the light source when it is on.

TIP: Failure to follow any of these instructions would void product warranties.